

North Logan Village

A Townhome Community

NW SEC 22 TOWNSHIP 12 NORTH RANGE 1 EAST SALT LAKE BASE AND MERIDIAN
400 EAST, 2000 NORTH
NORTH LOGAN, UTAH
PLAT

LEGAL DESCRIPTION

Part of Lot 7, Block 10, Plat "D" Logan Farm Survey located in the Northwest Quarter of Section 22, Township 12 North, Range 1 East of the Salt Lake Base described as follows:
Beginning at the Northeast Corner of Lot 7, Block 10, Plat "D" Logan Farm Survey and running
thence S 01°55'50" W 667.88 feet along the east line of said Lot 7 to the Southeast Corner of said Lot 7;
thence N 88°23'22" W 513.57 feet along the south line of said Lot 7;
thence N 01°32'21" E 540.54 feet;
thence N 88°22'16" W 154.16 feet to the west line of said Lot 7;
thence N 01°34'06" E 126.45 feet along said west line to the Northwest Corner of Lot 7;
thence S 88°27'37" E 672.22 feet along the north line of said Lot 7 to the point of beginning, containing 8.37 acres, more or less.

NARRATIVE/NOTES

1. ACREAGE: 8.35 ac.
2. ZONING: CCA
3. ALL COMMON AREA AND IS CONSIDERED TO BE AN EASEMENT FOR ALL UTILITY, IRRIGATION AND DRAINAGE PURPOSES. THIS INCLUDES THE INGRESS/EGRESS AREA.
4. ALL EXPENSES INVOLVING THE NECESSARY IMPROVEMENTS OR EXTENSIONS FOR A CULINARY WATER SYSTEM, SANITARY SEWER SYSTEM, GAS SERVICE, ELECTRICAL SERVICE, TELEPHONE SERVICE, CABLE TELEVISION SERVICE, GRADING AND LANDSCAPING, STORM DRAINAGE SYSTEMS, CURBS AND GUTTERS, FIRE HYDRANTS, SIDEWALKS, SIGNAGE, STREET LIGHTING AND OTHER IMPROVEMENTS SHALL BE PAID FOR BY THE SUBDIVIDER.
5. STRUCTURES AND OTHER IMPROVEMENTS LOCATED WITHIN THE SUBDIVISION INCLUDING THOSE LOCATED WITHIN LOTS AND COMMON AREAS ARE SUBJECT TO CC&R'S AFFECTING THIS PLAT.
6. THIS PLAT IS SUBJECT CERTAIN RIGHTS AND DUTIES AS SET FORTH IN SAID CC&R'S WHICH MAYBE AMENDED FROM TIME TO TIME.
7. EACH BUILDING SHALL HAVE AT LEAST ONE COMMERCIAL USE ESTABLISHED.

LEGEND

- BOUNDARY LINE
- CA COMMON AREA



ALLIANCE CONSULTING ENGINEERS
150 EAST 200 NORTH SUITE P
LOGAN, UTAH 84321
(435)755-5121
alliance@alliancece.com

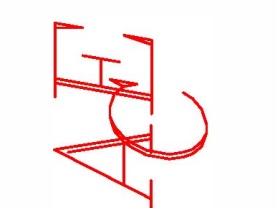

SUBDIVIDER: CONSTRUCTION, INC.
2700 N 2400 W
TREMONTON, UTAH

No.	REVISIONS / SUBMISSIONS	DATE

PROJECT TITLE: North Logan Village
A Townhome Community
NW SEC 22 TOWNSHIP 12 NORTH RANGE 1 EAST SALT LAKE BASE AND MERIDIAN
NORTH LOGAN, UTAH
PLAT

DATE: AUGUST, 2018
DRAWING No. 2

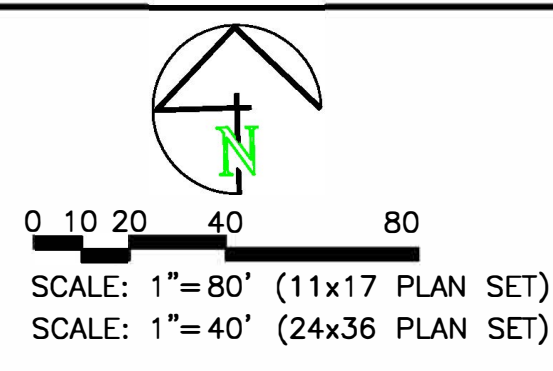

SCALE: 1"=80' (11x17 PLAN SET)
SCALE: 1"=40' (24x36 PLAN SET)

NORTH LOGAN CITY
04-083-0022

SPENDLOVE RESEARCH FOUNDATION
04-083-0016

REX S SPENDLOVE TR ETAL
04-083-0066

04-083-0018
IHC HOSPITALS INC

IHC HOSPITALS INC
04-083-0018

UTAH STATE UNIVERSITY
04-084-0021

PACIFICORP
04-084-0046

